

Quick Start Guide

54-Port Switch
ECS4530-54CSFP

Package Contents



1



2



3



4



5



6

1. ECS4530-54CSFP
2. Rack mounting kit — 2 brackets and 6 screws
3. Console cable — RJ-45 to D-Sub
4. Power cord

5. Adhesive foot pads
6. Documentation — *Quick Start Guide* (this document) and *Safety and Regulatory Information*

Overview



1. AC power socket
2. 22 x CSFP 1 GbE ports
3. 4 x RJ-45 / 2 x CSFP 1 GbE combo ports
4. 4 x SFP+ 10 GbE ports

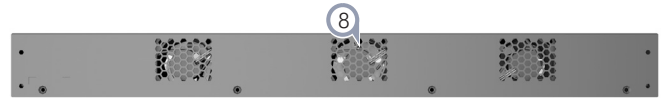

5. 2 x QSFP+ 20 GbE ports
6. RJ-45 Console port
7. RJ-45 Management port
8. 3 x Fans

Front LEDs

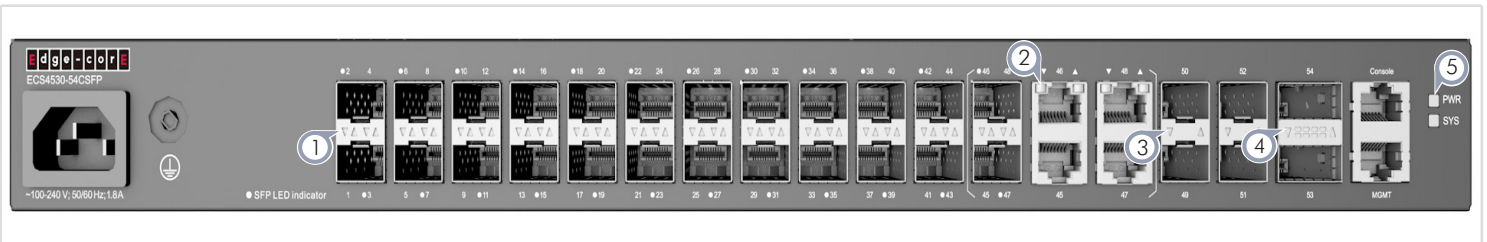

1. **CSFP Port LEDs:**
 - 1G Link/Activity — Green
2. **RJ-45 Port LEDs:**
 - 1G Link/Activity — Green
3. **SFP+ Port LEDs:**
 - 1G Link/Activity — Amber
 - 10G Link/Activity — Green

4. **QSFP+ Port LEDs:**
 - 20G Link/Activity — Green
5. **System LEDs:**
 - PWR LED — Green (OK)
 - SYS LED — Green (OK), Amber (fault)

Installation

Warning: For a safe and reliable installation, use only the accessories and screws provided with the ECS4530-54CSFP. Use of other accessories and screws could result in damage to the unit. Any damages incurred by using unapproved accessories are not covered by the warranty.
Avertissement: Pour une installation sûre et fiable, utilisez uniquement les accessoires et les vis fournies avec le ECS4530-54CSFP. L'utilisation d'autres accessoires et vis pourrait endommager l'appareil. Les dommages causés par l'utilisation d'accessoires non approuvés ne sont pas couverts par la garantie.

Caution: The server must be installed in a restricted-access location.
Attention: Le serveur doit être installé dans un emplacement à accès restreint.

i Note: The server has the Open Network Install Environment (ONIE) software installer preloaded on the server, but no software image. Information about compatible server software can be found at www.edge-core.com.
Note: The server drawings in this document are for illustration only and may not match your particular server model.

1 Mount the Switch

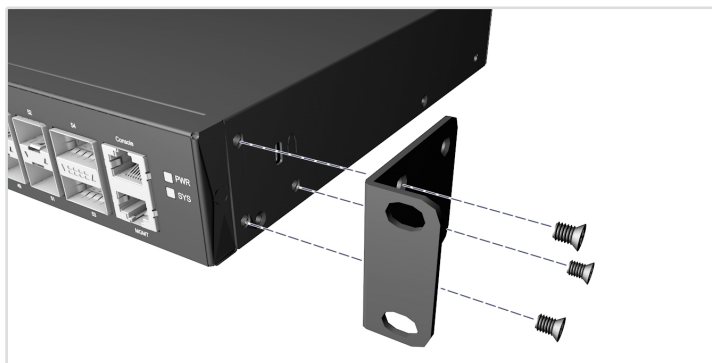

Attach the Brackets

Attach the brackets to each side of the switch using the included screws.

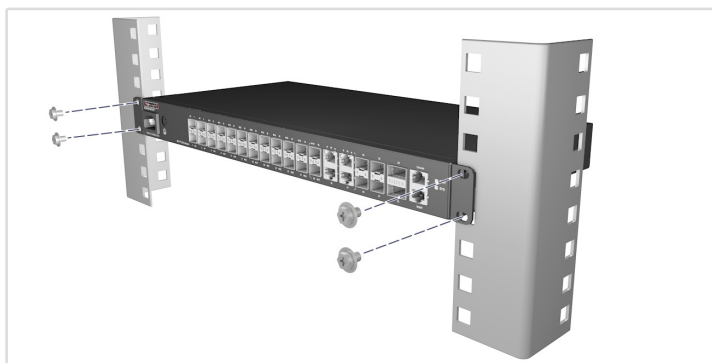

Mount the Switch

Use the screws and cage/clip nuts supplied with the rack to secure the switch in the rack.

2 Ground the Switch



Ground the switch

Attach a #6 AWG stranded copper wire to the grounding terminal on the switch, and the other end to the rack grounding point.

3 Connect Power

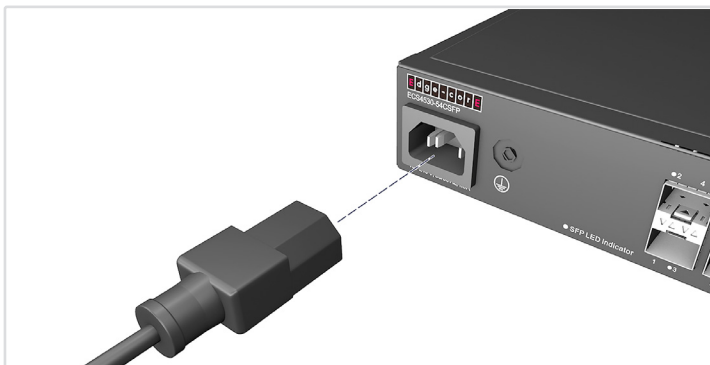

Connect AC power

Connect the AC power socket to an AC power source.

4 Make Network Connections

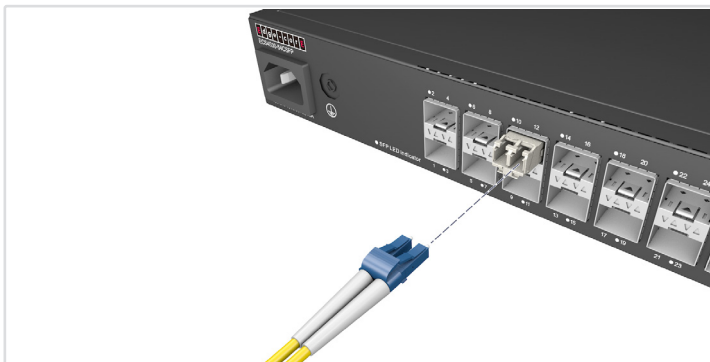

CSFP Ports

Install transceivers and then connect fiber optic cabling to the transceiver ports.

Supports 1 GbE CSFP transceivers (20 km distance) as well as SFP 1000BASE-BX, 1000BASE-LX, 1000BASE-SR, 1000BASE-SX, and 1000BASE-ZX transceivers.

i Note: When SFP transceivers are used, the port numbers are marked with ●.

5 Make Management Connections

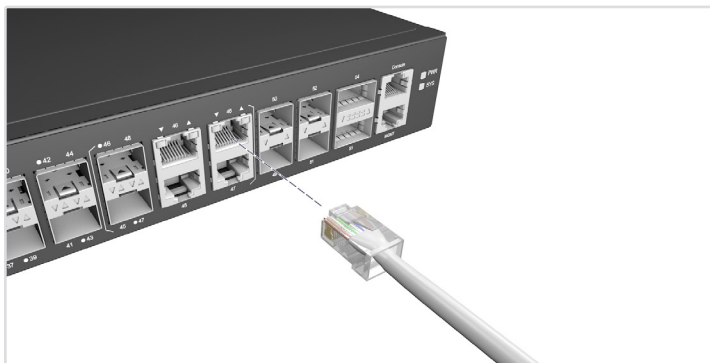

RJ-45 Ports

Connect Category 5e or better twisted-pair cables (UTP or STP is required) to the RJ-45 ports on the switch.



Console Port

Connect an RJ-45 to DE-9 straight-through console cable and then configure the serial connection: 115200 bps, 8 characters, no parity, one stop bit, 8 data bits, and no flow control.

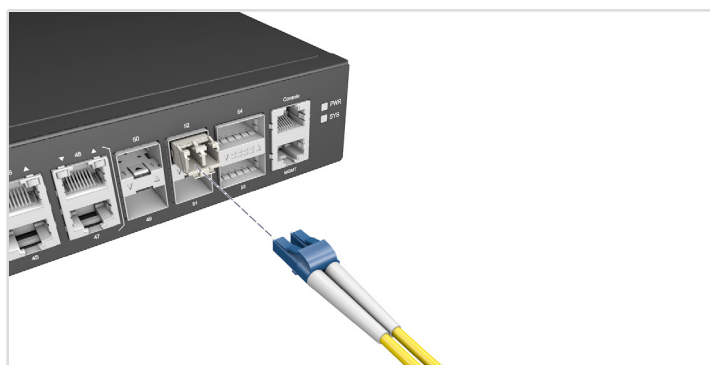

SFP+ Ports

Install transceivers and then connect fiber optic cabling to the transceiver ports. Alternatively, connect DAC/AOC cables directly to the SFP+ ports. Supports 1000BASE-BX, 1000BASE-LX, 1000BASE-SR, 1000BASE-SX, 1000BASE-ZX, 10GBASE-ER, 10GBASE-LR, and 10GBASE-ZR transceivers.

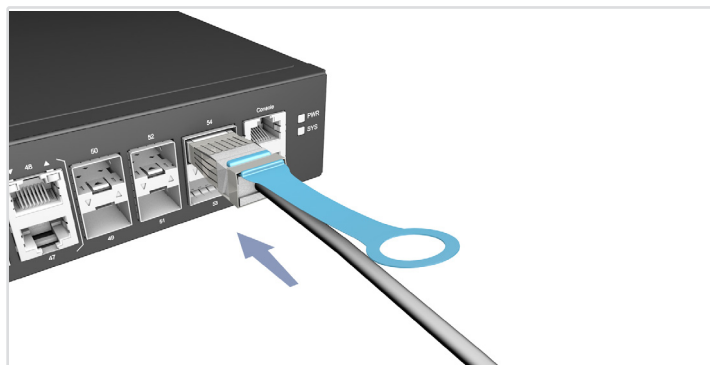

QSFP+ Ports

Install transceivers and then connect fiber optic cabling to the transceiver ports. Alternatively, connect DAC/AOC cables directly to the QSFP+ ports. Supports 40GBASE-CR4 DAC/AOC cables and transceivers with MPO connectors.

Hardware Specifications

Switch Interfaces

Management	1 x RJ-45 Console port 1 x RJ-45 Management port
Network	22 x 1 GbE CSFP ports 4 x 1 GbE RJ-45 / 2 x 1 GbE CSFP combo ports 4 x 10 GbE SFP+ ports 2 x 20 GbE QSFP+ ports

Switch Chassis

Form Factor	1 RU, full-rack width
Size (WxDxH)	442 x 220 x 43.6 mm (17.4 x 8.7 x 1.7 in)
Weight	3 kg (6.61 lb)
Temperature	Operating: 0° C to 50° C (32° F to 122° F) Storage: -40° C to 70° C (-40° F to 158° F)
Humidity	Operating: 5% to 90% (non-condensing) Storage: 5% to 95% (non-condensing)
Cooling System	3 x 16000 RPM fans supporting speed control
Power Consumption	85 Watts maximum
AC Input	100–240 VAC, 50-60 Hz, 1.8 A

Regulatory Compliances

Emissions	EN 55032:2015+AC:2016, Class A EN 61000-3-2:2014, Class A EN 61000-3-3:2013 VCCI Class A FCC Class A
Immunity	EN 55024:2010+A1:2015 IEC 61000-4-2/3/4/5/6/8/11
Safety	UL (CSA 22.2 No 62368-1 & UL62368-1 CB (IEC/EN60950-1 & IEC/EN 62368-1