

Quick Start Guide

64-Port GPON vOLT

ASGvOLT64



www.edge-core.com

Package Contents



1



2



3



4



5

1. ASGvOLT64
2. Rack mounting kit—2 brackets and 24 screws
3. 2 x Power cord

4. Console cable—RJ-45 to D-Sub
5. Documentation—*Quick Start Guide* (this document) and *Safety and Regulatory Information*

Overview

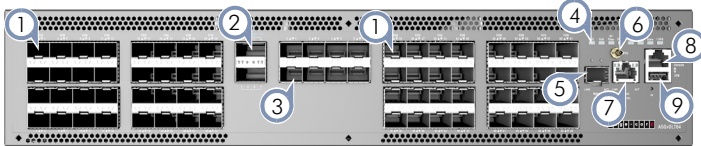

1. 64 x SFP GPON ports
2. 2 x QSFP28 40G/100G ports
3. 8 x SFP28 10G/25G ports
4. System LEDs
5. 1 x SFP Management port
6. 1 x 1PPS

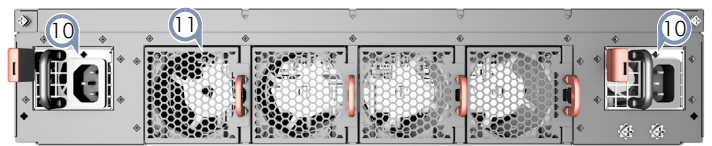

7. 1 x RJ45 Management port
8. 1 x RJ45 Console port
9. 1 x USB port
10. 2 x AC PSUs
11. 4 x Fan trays

System LEDs

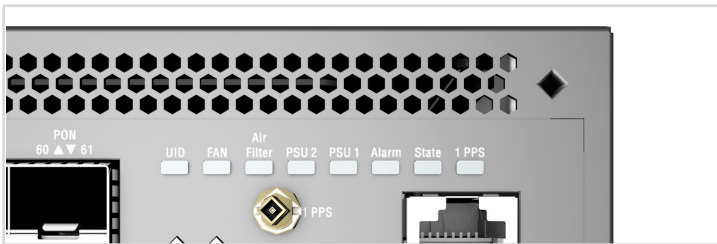

- UID LED:** Blinking blue
- FAN LED:** Off (OK), Red (fault)
- Air Filter LED:** Off (OK), Red (change filter)
- PSU LEDs:** Green (OK), Red (fault)
- Alarm LED:** Green (OK), Blue (minor), Red (major)
- State LED:** Green (OK), Blue (initializing), Red (fault)
- 1PPS LED:** Green (OK)

Port LEDs



- SFP GPON Port LEDs:** Green (link up and in service), Blue (disable), Red (fault), Blinking (activity)
- QSFP28 Port LEDs:** Green (100G), Blue (40G), Orange (4G), Blinking (activity)
- SFP28 Port LEDs:** Green (25G), Blue (10G), Orange (1G), Blinking (activity)

FRU Replacement

PSU Replacement

1. Remove the power cord.
2. Press the release latch and remove the PSU.
3. Install replacement PSU with matching airflow direction.

Fan Tray Replacement

1. Loosen the fan tray screw.
2. Remove fan tray from the chassis.
3. Install replacement fan with matching airflow direction.

Airflow Reversal

1. F2B Airflow

Remove front-to-back (F2B) airflow fan trays (red handles) and PSUs (red release latches).

2. B2F Airflow

Install back-to-front (B2F) airflow fan trays (blue handles) and PSUs (blue release latches).



Installation



Warning: For a safe and reliable installation, use only the accessories and screws provided with the device. Use of other accessories and screws could result in damage to the unit. Any damages incurred by using unapproved accessories are not covered by the warranty.

Avertissement: Pour une installation sûre et fiable, utilisez uniquement les accessoires et les vis fournies avec l'appareil. L'utilisation d'autres accessoires et vis pourrait endommager l'appareil. Les dommages causés par l'utilisation d'accessoires non approuvés ne sont pas couverts par la garantie.



Caution: The device includes plug-in power supplies (PSUs) and fan tray modules that are installed into its chassis. Make sure all installed modules have a matching airflow direction.

Attention: Le appareil comprend des modules d'alimentation et de modules de ventilation installés dans son châssis. Assurez-vous que tous les modules installés ont une direction d'air adaptée.



Note: The device has the Open Network Install Environment (ONIE) software installer preloaded on the switch, but no switch software image. Information about compatible switch software can be found at www.edge-core.com.

Note: Model name and approval markings are indicated on the product label located on the bottom of the device.

1 Mount the Device

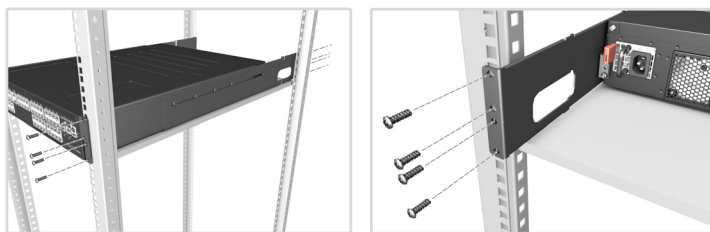

1. Attach the Brackets

Use the included screws to attach the left and right brackets.

2. Mount the Device

Mount the device in the rack and secure it with rack screws.

2 Ground the Device



Ensure the Rack is Grounded

Ensure the rack on which the device is to be mounted is properly grounded and in compliance with ETSI ETS 300 253. Verify that there is a good electrical connection to the grounding point on the rack (no paint or isolating surface treatment).

Ground the Device

Attach a #14 AWG grounding wire (not included) to the grounding point on the device rear panel. Then connect the other end of the wire to rack ground.

3 Connect Power

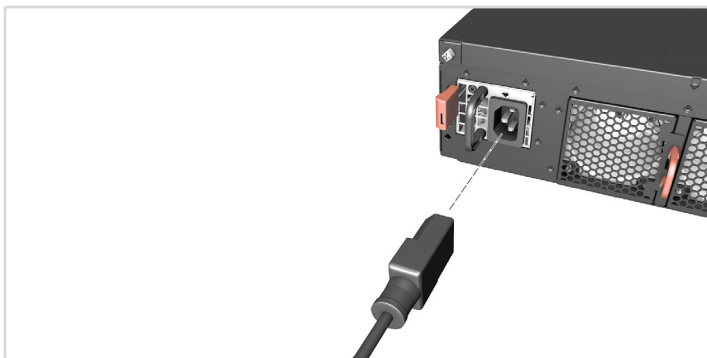

AC or DC Power

Connect the two AC or DC PSUs to a power source.



Caution: Use a UL/IEC/EN 60950-1 certified power supply to connect to a DC converter, and a #14 AWG (for -36 – -72 VDC PSU).

Attention: Utilisez une alimentation certifiée UL/IEC/EN 60950-1 pour le connecter à un convertisseur CC et un câble AWG #14 (pour -36 – -72 VDC) pour vous connecter à une alimentation CC.

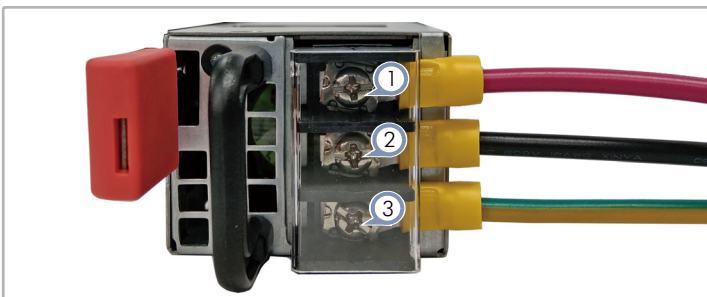

1. Connect the RTN return. (red wire).
2. Connect the -36 – -72 VDC (black wire).
3. Connect the Chassis Ground (yellow-green wire).



Note: DC terminal screws should be tightened to a torque of 6.6 in-lbs.

4 Verify Device Power

Check the PSU LEDs

The PSU1/PSU2 LEDs should be on green when operating normally.

5 Make Network Connections

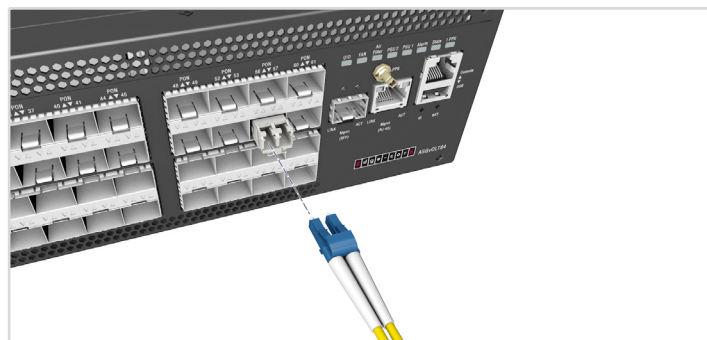

1. SFP GPON slots

First install GPON transceivers and then connect fiber optic cabling to the transceiver ports.

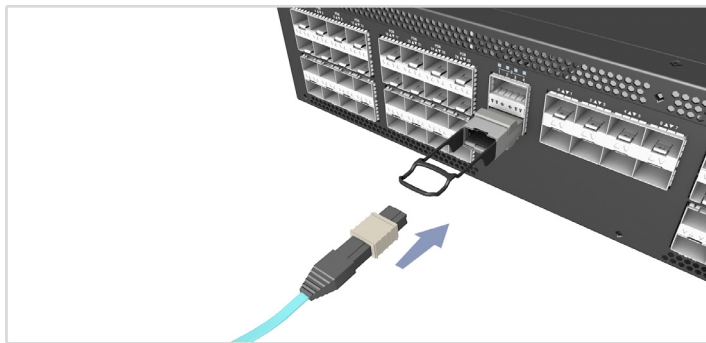

2. QSFP28 slots

First install QSFP28 transceivers and then connect fiber optic cabling to the transceiver ports.

3. SFP28 slots

First install SFP28 transceivers and then connect fiber optic cabling to the transceiver ports.

6 Connect the Timing Port

1PPS port

Use a coax cable to connect the 1-pulse-per-second (1PPS) SMB port to another synchronized device.

7 Make Management Connections



1. SFP/RJ-45 slots

Combo RJ-45/SFP Ethernet out-of-band (OOB) management port to provide a network management connection.

2. RJ-45 Console port

Connect the included console cable and then configure the serial connection: 115200 bps, 8 characters, no parity, one stop bit, 8 data bits, and no flow control.

3. USB port

Connect using a standard USB cable to a storage device.

Hardware Specifications

Chassis

Size (WxDxH)	477 x 600 x 89 mm (18.78 x 23.62 x 3.50 in)
Weight	16.51 kg (36.40 lbs)
Temperature	Operating: 0° C to 40° C (32° F to 104° F) Storage: -40° C to 70° C (-40° F to 158° F)
Humidity	Operating: 5% to 95% (non-condensing)

System Input Rating

AC Input	100-240 Vac, 50-60 Hz, 5.5-2.3 A
DC Input	-36 – -72 Vdc, 16-8 A
Power Consumption	480 W

Regulatory Compliances

Emissions	EN 55032:2015+AC:2016, Class A EN 61000-3-2:2014, Class A EN 61000-3-3:2013 FCC Class A
Immunity	IEC 61000-4-2/3/4/5/6/8/11 EN 55024:2010+A1:2015 EN 55035:2017
Safety	UL (UL 62368-1 & CSA C22.2 No. 62368-14 CB (IEC/EN 60950-1, IEC/EN 62368-1)

快速入門指南

64 連接埠 GPON vOLT

ASGvOLT64

Edge-core[®]

www.edge-core.com

包裝內容物



1



2



3



4



5

1. ASGvOLT64
2. 機櫃安裝套件 — 2 個托架和 24 個螺絲
3. 2 x 電源線

4. 控制電纜 — RJ45 轉 D-Sub
5. 文件 — 快速入門指南 (本文件) 及安全及法規資訊

簡介

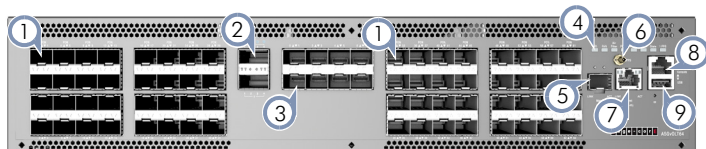

1. 64 x SFP GPON 連接埠
2. 2 x QSFP28 40G/100G 連接埠
3. 8 x SFP28 10G/25G 連接埠
4. 系統 LED
5. 1 x SFP 管理埠
6. 1 x 1PPS

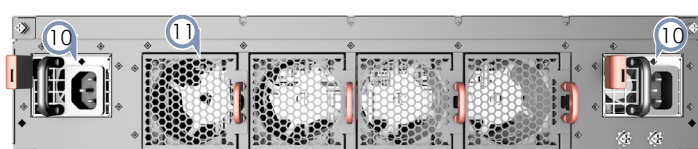

7. 1 x RJ45 管理埠
8. 1 x RJ45 控制埠
9. 1 x USB 連接埠
10. 2 x AC PSU
11. 4 x 風扇托盤

系統 LED

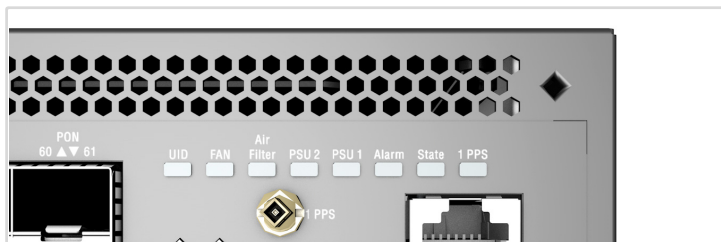

- UID LED：閃爍藍燈
- 風扇 LED：關閉 (良好)、紅燈 (故障)
- 空氣濾清器 LED：關閉 (良好)、紅燈 (更換濾網)
- PSU LED：綠燈 (良好)、紅燈 (故障)
- 警報 LED：綠燈 (良好)、藍燈 (次要)、紅燈 (主要)
- 狀態 LED：綠燈 (良好)、藍燈 (初始化)、紅燈 (故障)
- 1PPS LED：綠燈 (良好)

更換 FRU

更換 PSU

1. 取下電源線。
2. 按住釋放桿並取出 PSU。
3. 安裝氣流方向相符的替換 PSU。

更換風扇托盤

1. 鬆開風扇托盤螺絲。
2. 從機殼內取出風扇托盤。
3. 安裝氣流方向相符的替換風扇。

連接埠 LED



- SFP GPON 連接埠 LED：綠燈 (上行鏈路與運作中)、藍燈 (停用)、紅燈 (故障)、閃爍 (活動)
- QSFP28 連接埠 LED：綠燈 (100G)、藍燈 (40G)、橘燈 (4G)、閃爍 (活動)
- SFP28 連接埠 LED：綠燈 (25G)、藍燈 (10G)、橘燈 (1G)、閃爍 (活動)

氣流反向

1.F2B 氣流

移除前至後 (F2B) 氣流風扇 (紅色握把) 及 PSU (紅色釋放桿)。

2.B2F 氣流

安裝後至前 (B2F) 氣流風扇托盤 (藍色握把) 及 PSU (藍色釋放桿)。



* 1 5 0 2 0 0 0 0 2 4 2 4 A R 0 1 *

安裝



警告：為確保安全且可靠的安裝，請使用裝置隨附的配件與螺絲。使用其他來源的配件與螺絲可能導致配件損壞。使用未經許可配件所造成之損壞，不在保固範圍內。



注意：裝置包含安裝在機箱中的插入式電源供應器 (PSU) 和風扇托盤模組。確定所有已安裝之模組氣流方向一致。



注釋：裝置具有預載於交換器上的開放網路安裝環境 (ONIE) 軟體安裝程式，但沒有交換器軟體映像檔。關於相容交換器軟體的資訊，可上此網站：www.edge-core.com。

注釋：模組名稱與核定標誌皆顯示在裝置底部的產品標籤上。

1 安裝裝置

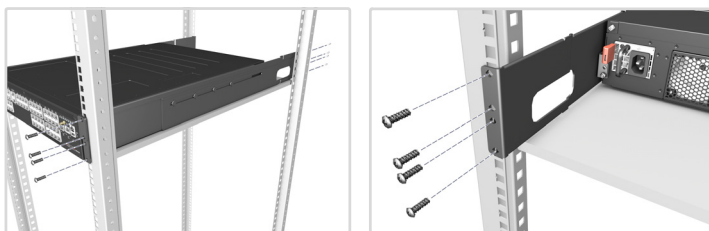

1. 安裝托架

使用內附的螺絲安裝左右托架。

2. 安裝裝置

將裝置裝到機櫃中並用機櫃螺絲固定。

2 將裝置接地



確保機架接地

確認安裝裝置之機櫃已正確接地，且符合 ETSI ETS 300 253。確認與機櫃接地點間有良好的電氣連接性（無油漆或絕緣表面處理）。

將裝置接地

將 #14 AWG 接地線（未隨附）連接至裝置後面板上的接地點。接下來，將接地線另一端連接至機櫃接地。

3 連接電源

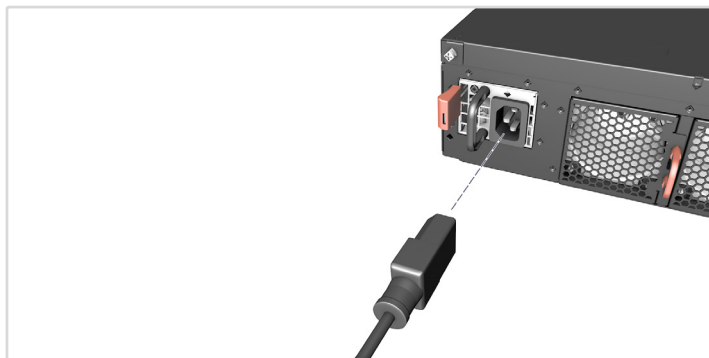

AC 或 DC 電源

連接兩部 AC 或 DC PSU 至電源。



注意：使用 UL/IEC/EN 60950-1 認證的電源供應器連接 DC 轉換器，以及 #14 AWG（適用於 -36 – -72 VDC PSU）。

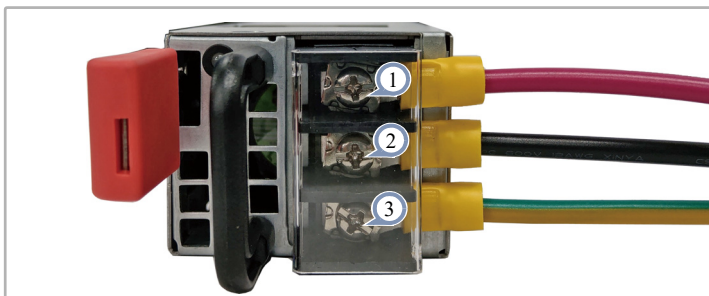

1. 連接 RTN 回路。（紅線）。
2. 連接 -36 – -72 VDC（黑線）。
3. 連接底座接地（黃綠線）。



注釋：DC 端子螺絲應鎖緊至 6.6 in-lbs 扭矩。

4 確定裝置電源

檢查 PSU LEDs

正常操作時，PSU1 / PSU2 LED 應亮綠燈。

5 進行網路連線

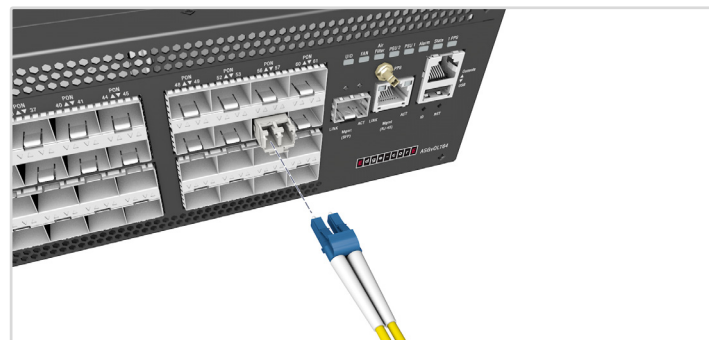

1. SFP GPON 插槽

首先安裝 GPON 收發器，然後將光纖電纜連接至收發器連接埠。

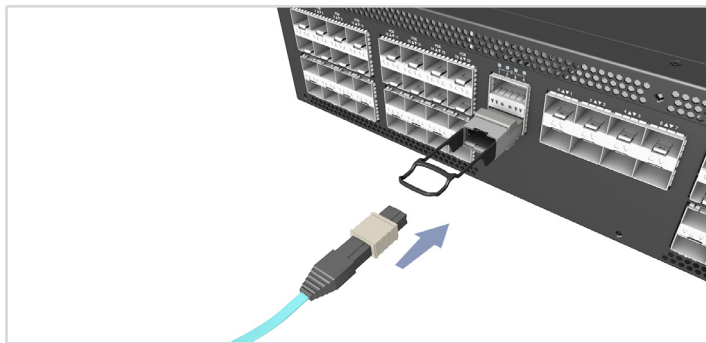

2. QSFP28 插槽

先安裝 QSFP28 收發器，再將光纖電纜連接至收發器連接埠。

3. SFP28 插槽

先安裝 SFP28 收發器，再將光纖纜線連接至收發器連接埠。

6 連接時序連接埠

1PPS 連接埠

使用同軸纜線連接 1 每秒脈衝 (1PPS) SMB 連接埠至其他同步化裝置。

7 進行管理連接



1. SFP/RJ-45 插槽

結合 RJ-45/SFP 乙太網路頻外 (OOB) 管理埠以提供網路管理連線。

2. RJ-45 控制埠

連接隨附的控制線，接著配置串列連接：115200 bps、8 個字元、無奇偶 (檢驗碼)、1 個停止位元、8 個資料位元，且無流量控制。

3. USB 連接埠

使用標準 USB 纜線至儲存裝置。

硬體規格

底座

尺寸 (寬 x 深 x 高) 477 x 600 x 89 mm (18.78 x 23.62 x 3.50 in)

重量 16.51 公斤 (36.40 磅)

溫度 操作：0° C 至 40° C (32° F 至 104° F)
儲存：-40° C 至 70° C (-40° F 至 158° F)

濕度 操作：5% 至 95% (無冷凝)

系統輸入額定值

AC 輸入 100-240 Vac、50-60 Hz、5.5-2.3 A

DC 輸入 -36 – -72 Vdc、16-8 A

耗電量 480 W

符合法規

輻射 EN 55032:2015+AC:2016, Class A
EN 61000-3-2:2014, Class A
EN 61000-3-3:2013
FCC Class A

耐受 IEC 61000-4-2/3/4/5/6/8/11
EN 55024:2010+A1:2015
EN 55035:2017

安全性 UL (UL 62368-1 & CSA C22.2 No. 62368-14
CB (IEC/EN 60950-1, IEC/EN 62368-1)